

NOTES

1. This drawing is to be used for planning and building control purposes only.
2. It is the client's responsibility to ensure that all necessary permissions are obtained.
3. The client is responsible for ensuring that the drawing is used in accordance with the intended purpose.
4. The client is responsible for ensuring that the drawing is used in accordance with the intended purpose.

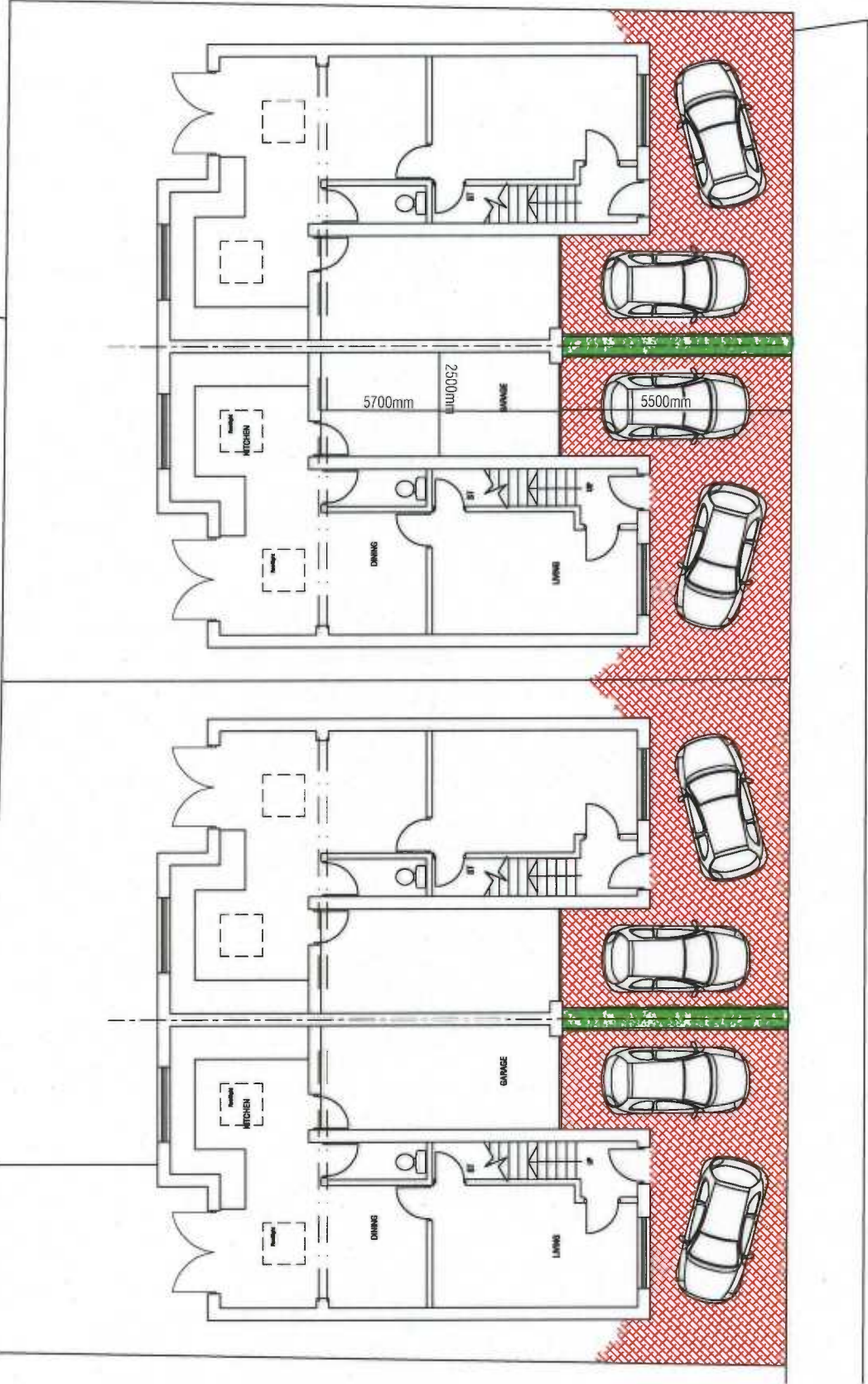

Proposed Site Plan
(Scale 1:50 @ A3)



11, Derry Road West,
Crumlin, Dublin 12, Ireland
Tel: 01274 2888
Fax: 01274 2888
www.poa.ie
www.poa.ie

poa

PROJECT	PETER CARTER		
CLIENT	PETER CARTER		
DESIGNER	POA		
DATE	18/7/11	SCALE	1:50
DRAWN	EE/BC	CHECKED	DO
REVISION	18/7-11 08		